

### Features

- Includes face plate with handle, bath spout, shower arm and flange and showerhead.
- Scroll lever handle controls both on/off activation and temperature setting.
- Includes 5-3/4" non-diverter bath spout with 1/2" NPT connection.
- Integrated push button diverter.
- Includes single function 2.5 gpm (9.5 l/min) showerhead.
- Coordinates with Revival faucets and accessories to complete your bathroom.
- Pressure-balancing diaphragm technology maintains outlet temperature within +/-3 degrees Fahrenheit during water pressure fluctuations.
- Showerhead features MasterClean™ sprayface for easy cleaning.
- Premium material construction with metal handle ensures reliability and durability.
- KOHLER finishes resist corrosion and tarnishing.
- Trim set requires valve to complete installation.
- Premium material construction for durability and reliability
- Completes Revival design solution with KOHLER fixtures and accessories
- 5-3/4" Spout
- Single function showerhead with showerarm
- Trim only, requires valve to complete installation

### Installation

- Bath- or deck-mount.

### Required Products/Accessories

K-11748 Series Rite-Temp® Valves



### Codes/Standards

ASME A112.18.1/CSA B125.1





DOE - Energy Policy Act 1992

### KOHLER® Faucet Lifetime Limited Warranty

See website for detailed warranty information.

### Available Colors/Finishes

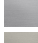
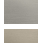
*Color tiles intended for reference only.*

Color	Code	Description
	CP	Polished Chrome
	AF	Vibrant® French Gold
	PB	Vibrant® Polished Brass
	G	Brushed Chrome
	BN	Vibrant® Brushed Nickel
	BV	Vibrant® Brushed Bronze

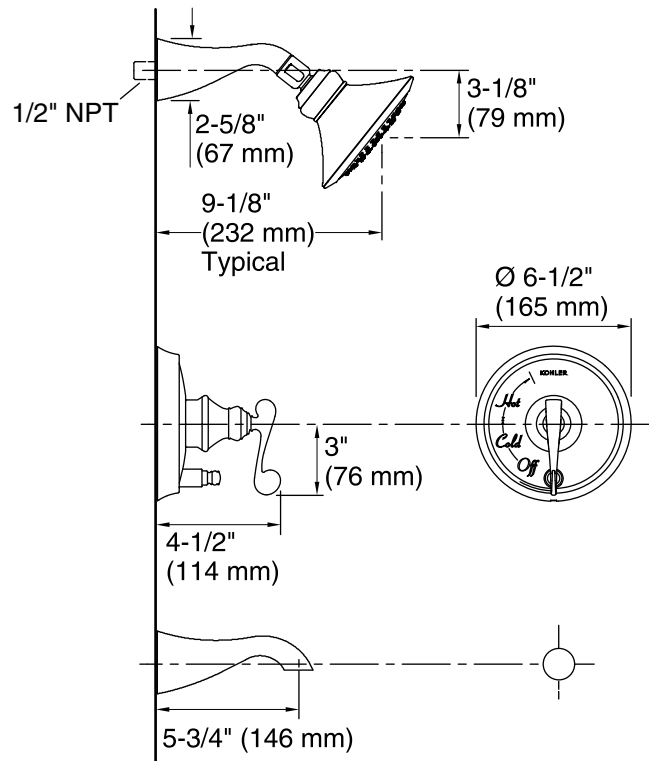

**Technical Information**

All product dimensions are nominal.

**Notes**

Install this product according to the installation instructions.

Avoid cross-flow conditions. Do not install shut-off device on either valve outlet.

Install straight pipe or tube drop of 7" (178 mm) to 18" (457 mm) with single elbow between the valve and wall-mount spout.