



8 Degree™ Under-Mount Kitchen Sink K-3673

Features

- 36-inch minimum base cabinet width.
- Single bowl.
- 9-3/4" depth provides generous workspace.
- Offset drain increases workspace in the sink and storage space underneath.
- Includes installation hardware, wineglass rack, and bottom sink rack.
- SilentShield® sound-absorption technology offers quieter performance.

Material

- Handcrafted from 16-gauge stainless steel.
- Premium 16-gauge stainless steel.

Installation

- No faucet holes.
- Undermount.

Recommended Products/Accessories

K-6137 Sink Rack
K-8801 Sink Strainer
K-8799 Sink Strainer
K-23726 Drain treatment
K-23729 Stainless steel cleaner

Optional Products/Accessories

K-3140 Cutting Board
K-11352 Disposal Flange with Stopper

Included Components

Additional Components:

Hardware kit(s)
Wine glass rack
bottom bowl rack



Codes/Standards

ASME A112.19.3/CSA B45.4

Lifetime Limited Warranty for KOHLER® Stainless Steel Sinks

See website for detailed warranty information.

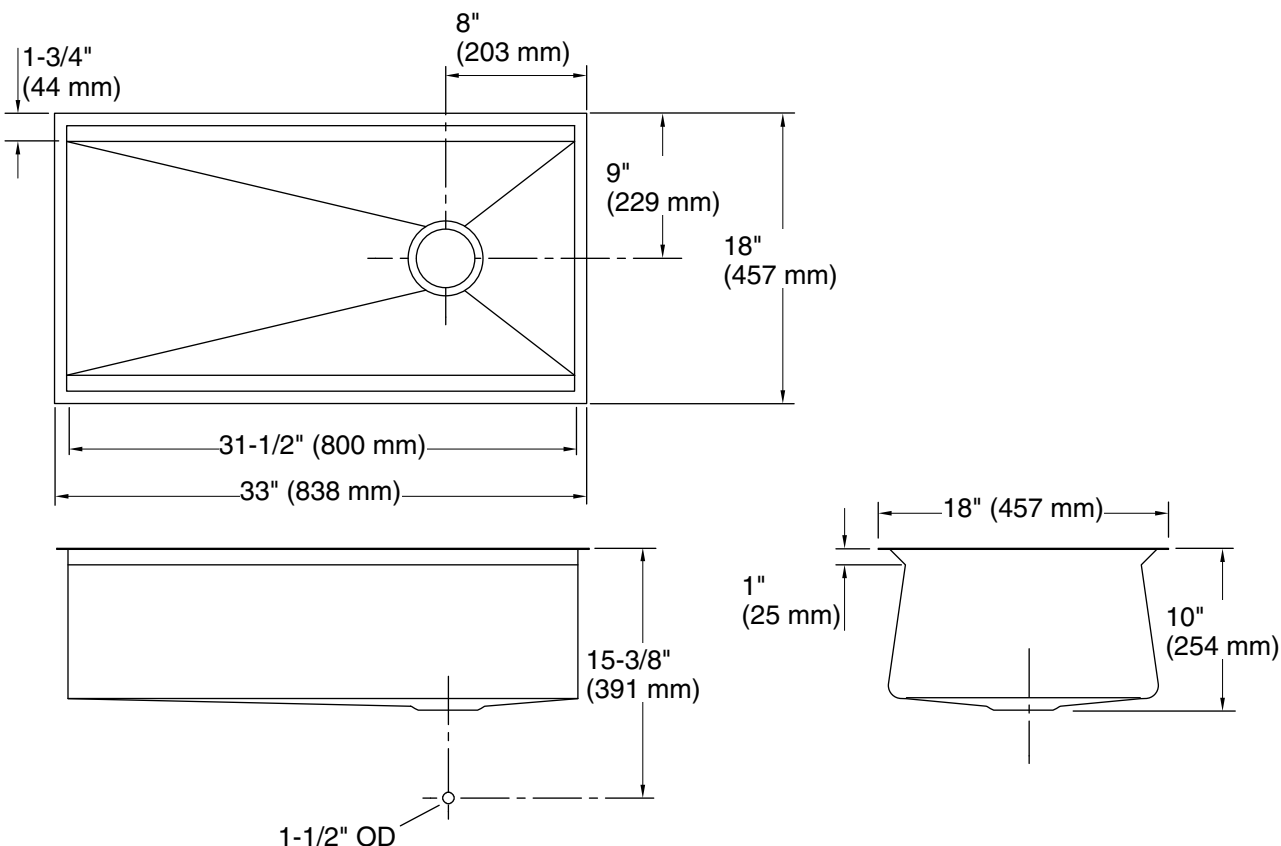

Technical Information

All product dimensions are nominal.

Bowl configuration: Single

Installation: Under-mount

Min. base cabinet width: 36" (914 mm)

Bowl area (Only):
Length: 31-1/2" (800 mm)
Width: 16-1/2" (419 mm)
Bowl depth: 9-3/4" (248 mm)
Water depth: 9-3/4" (248 mm)

Drain hole: 3-5/8" (92 mm)

Template: 1093327-7, required, included

Notes

Install this product according to the installation instructions.